

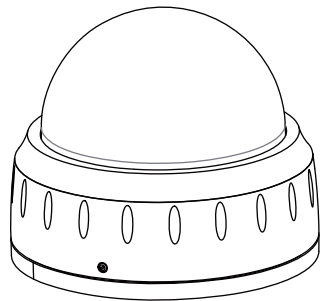

## Analog HD Indoor Dome Camera User Guide



2MP Day / Night  
Color Camera

### Regulatory Compliance

V531-DK018-202  
VER. 06/2017

Emissions: --CE:  
--EN55022  
--EN55011  
--FCC  
--47 CFR Part15 Subpart B  
--ANSI C63.4  
--ICES-003  
Immunity: --CE:  
--EN55024  
--EN50130-4

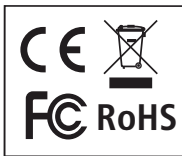

**FCC COMPLIANCE:**  
This equipment has been tested and found to comply with the limits for a Class B digital device, pursuant to Part 15 of the FCC Rules. These limits are designed to provide reasonable protection against harmful interference in a residential installation. This equipment generates uses and can radiate radio frequency energy and, if not installed and used in accordance with the instructions, may cause harmful interference to radio communications. However, there is no guarantee that interference will not occur in a particular installation.  
If this equipment does cause harmful interference to radio or television reception, which can be determined by turning the equipment off and on, the user is encouraged to try to correct the interference by one or more of the following measures:  
• Reorient or relocate the receiving antenna.  
• Increase the separation between the equipment and receiver.  
• Connect the equipment into an outlet on a circuit different from that to which the receiver is connected.  
• Consult the dealer or an experienced Radio/TV technician for help.

**CISPR 22 WARNING:**  
This is a Class B product. In a domestic environment this product may cause radio interference in which case the user may be required to take adequate measures.  
**POWER SUPPLY REQUIREMENTS:**  
For use with listed Audio/Video product and only connected to 15W or less power supply.  
\*Power supply should be a NEC Class 2 / LPS Supply.  
**EQUIPMENT MODIFICATION CAUTION:**  
Equipment changes or modifications not expressly approved by seller.  
The party responsible for FCC compliance could void the user's authority to operate the equipment and could create a hazardous condition.

This class B digital apparatus complies with Canadian ICES-003.  
Cet appareil numérique de la classe B est conforme à la norme NMB-003 du Canada.

### About this Sheet

Thank you for purchasing this product.  
Before operating this unit, please read this sheet carefully.  
For detailed descriptions about the unit's specification, please refer to the following content. For any information or inquiry, please contact your local dealer.

Product illustration only for installation or adjustment reference,  
please take the product as standard.

Please note that the specifications and appearance of this unit  
are subject to change for further improvements without prior notice.

### Hardware Kit Contents

- Quick install adaptor x 1
- Torx driver x 1
- D5 fixing screws x 3
- T6 fixing screw x 1
- Wall plugs x 3
- Power lead x 1
- Cable entry sealing plug  
(1/2", for quick install adaptor use) x 1
- Cable entry sealing plug  
(3/4", for dome base use) x 1

### Camera Specifications

General Specifications			
TV System		NTSC / PAL	
Scanning Frequency		NTSC: 60Hz / PAL: 50Hz	
Iris Type		Fixed Iris	
Image Sensor		1/2.7" CMOS Sensor	
Effective Picture		2 Megapixel	
Resolution		1928(H)*1088(V)	
S/N Ratio		≥41 dB	
Minimum Illumination		0.01 Lux	
Video Output		AHD/TVI/CVI/CVBS	
Power Source		DC 12V±10% , AC 24V±20%	
Power Consumption		7.2 W	
Operating Temperature		-10℃ -+50℃	
Storage Temperature		-20℃ -+60℃	
Functional Specifications			
AES		AUTO/1/50(1/60)-1/50000 Sec	
BLC		AUTO	
AGC Gain Control		Support	
Day/Night Control		TDN(External Control/Color/B&W)	
White Balance		ATW/AWC/Indoor/Outdoor/Manual	
UTC Remotely Transmission		DVR Remotely Control	
D-WDR		OFF/AUTO/ON	
Defog		OFF/AUTO	
Motion Detection		OFF/ON	
Privacy Zone		4 Privacy Zone	
Sharpness		AUTO/OFF	
Digital Noise Reduction		2D/3D NR	
Language		English/Simplified Chinese/Traditional Chinese/German/ French/Italian/Spanish Polish/Russian/Portuguese/Dutch/ Turkish	
Lens Specifications			
Focal Length		2.8-12 mm	6.0-22 mm
F No.		F1.4-F360	F2.2-F360
Field of View	H	100°-32°	46.4°-16.3°
	V	72°-24°	34.8°-12.2°
	D	140°-40°	58°-20.4°

### Camera Overview

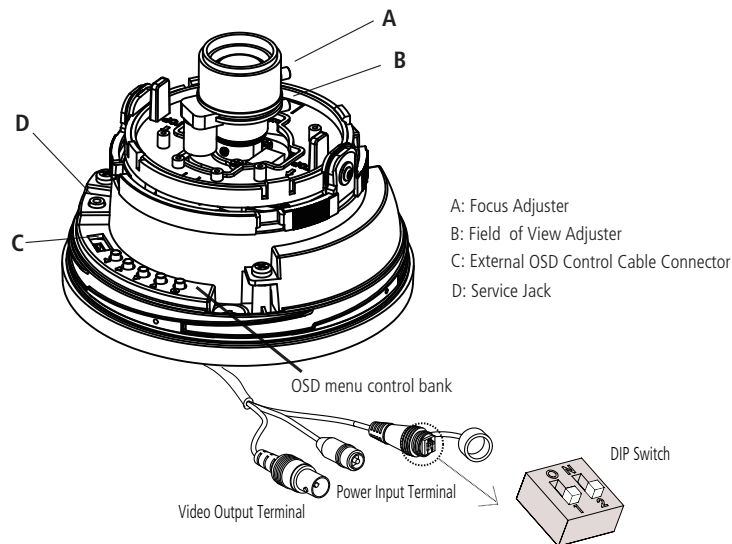

### Before Installation

This dip switch cable is for setting of video signal mode, CVBS is set as factory default.  
If any of HD over Coaxial Technology is available and intend to be used  
(e.g. DVR, Video Server), please adjust to corresponded video signal before installation  
according to the required specifications.



### Camera Adjustments

The following illustrates Service Board. Camera adjustments can be made by  
using keys on the control bank.

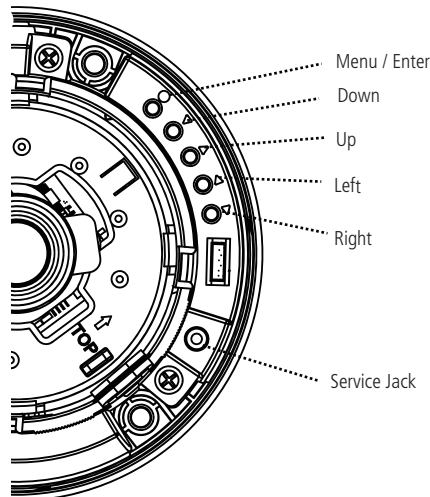

### Installation

#### Precautions

- Do not attempt to dismantle the camera module mounted within the dome.  
There are no user serviceable parts within the camera module.  
Refer servicing to qualified personnel.
- Handle the camera with care. Do not abuse the camera.  
Avoid striking or shaking it. Improper handling and storage could damage the camera.
- Do not operate the camera beyond its temperature,  
humidity or power source rating. Please refer to the environmental information provided overleaf.

#### Emissions

- **FCC COMPLIANCE:** This equipment complies with Part 15 of the FCC rules for intentional radiators and Class B digital devices when installed and used in accordance with the instruction manual. Following these rules provides reasonable protection against harmful interference from equipment operated in a commercial area. This equipment should not be installed in a residential area as it can radiate radio frequency energy that could interfere with radio communications, a situation the user would have to fix at their own expense.

#### Install Methods

- A. By using the base mounting holes  
B. By using the quick install adaptor

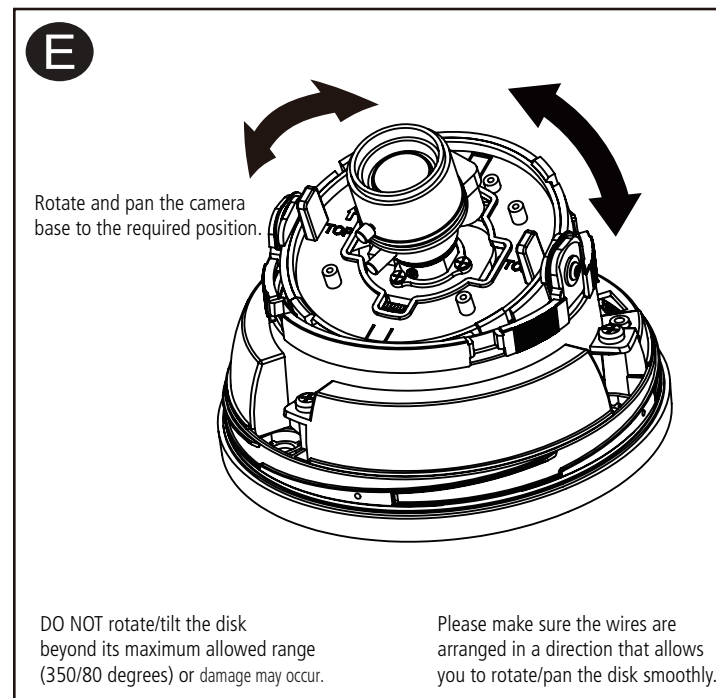
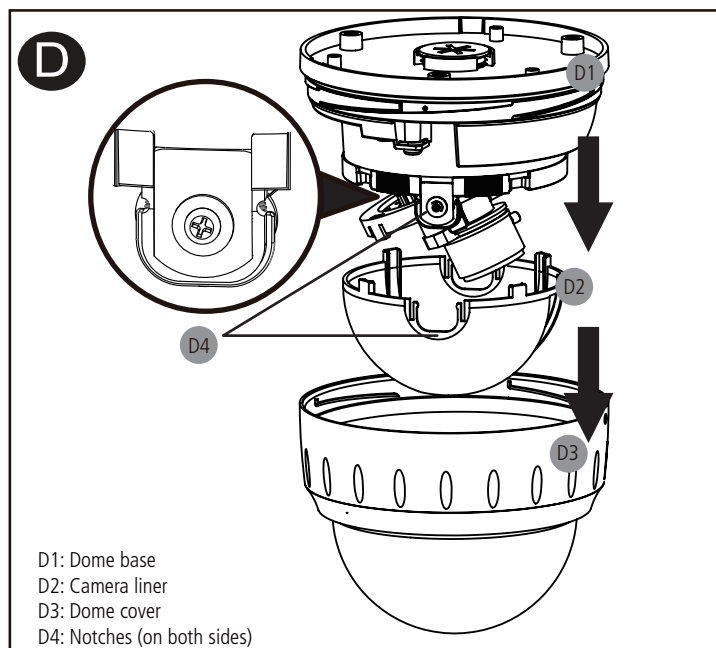
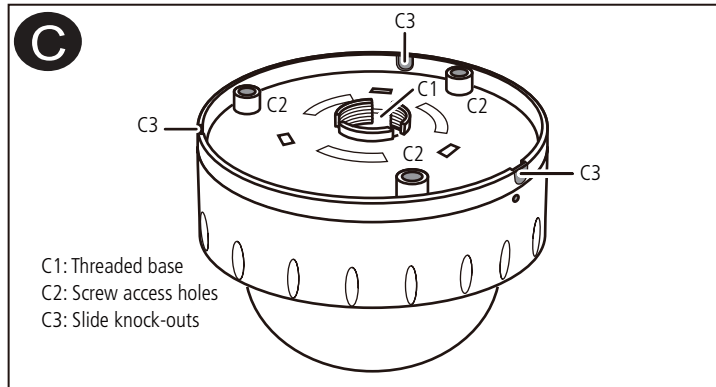
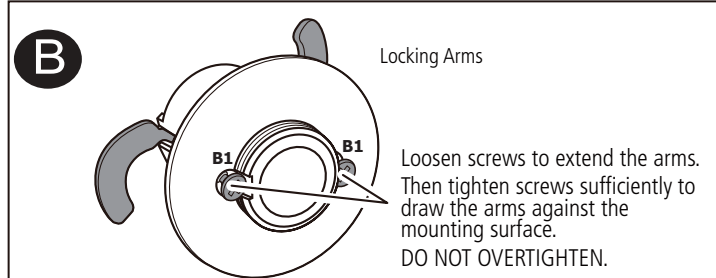
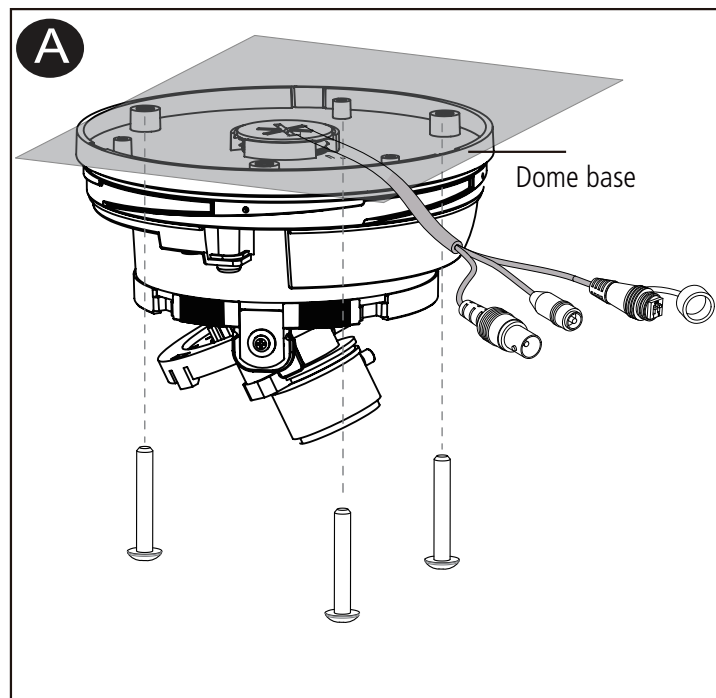

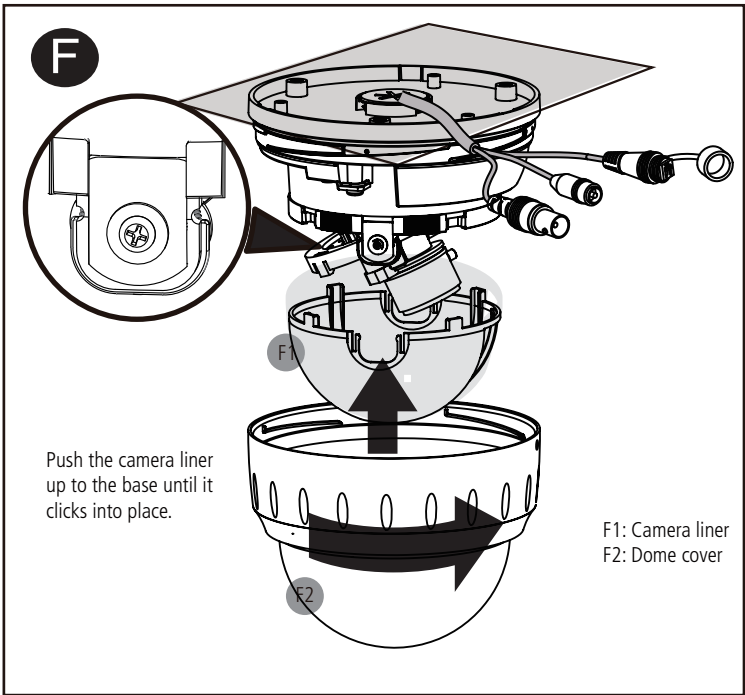

Push the camera liner up to the base until it clicks into place.

F1: Camera liner  
F2: Dome cover

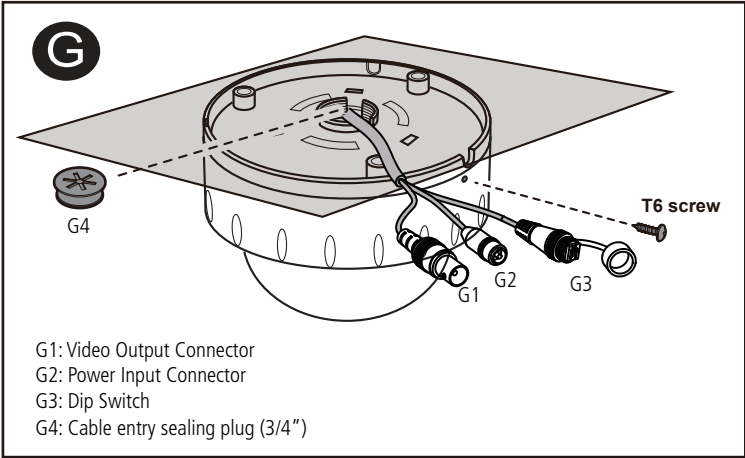

G1: Video Output Connector  
G2: Power Input Connector  
G3: Dip Switch  
G4: Cable entry sealing plug (3/4")

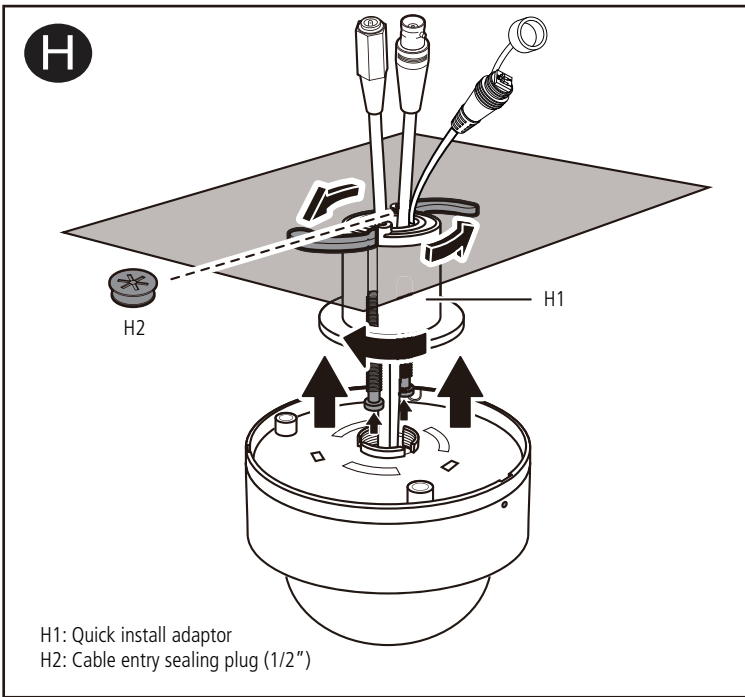

H1: Quick install adaptor  
H2: Cable entry sealing plug (1/2")

## How to install

1.Remove the dome cover and the camera liner  
Gently turn the dome cover counter-clockwise to unlock and pull free of the dome base. Remove the camera liner by gently pulling it free of the two notches (D4) in the camera base (see fig D).

2.Use the template to mark-out and prepare the mounting area  
When mounting the dome to a ceiling or wall using screws, first knock out the screw access holes (C2) that correspond to the template marks "D5". This can be done by using a cross-point screwdriver. When mounting the dome to a ceiling using the quick install adaptor, use the template to cut a hole as the circle marked "T5" with a hole cutter (See Step 9).

3.Open the required knock-out panel ( if surface wiring is to be used)  
Use a sharp knife or side cutter pliers to cut one of the side knock-outs (C3) to the size required to allow cable entry. Be careful not to hurt yourself or damage the camera when using knives and side cutter pliers.

4.Mount the dome enclosure  
Using one of the mounting schemes below (Template), fix the dome enclosure in place.  
\*Please note that some mounting tools are optional.

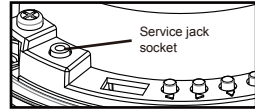

5.Connect the wiring  
Feed the pre-connected main lead (that feeds into the connections G1 and G2) through the appropriate point and connect it to your video out and power in cables. A service jack socket is also provided for temporary video connection when focusing the camera, using an optional service cable (SVC-CABLE).

6.Adjust the camera position  
You can adjust the focusing position by rotating and panning the camera base (see fig E).

7.Install the camera liner  
Carefully fit the camera liner (F1) over the camera base so that it snaps into place as shown in fig. F and does not obstruct the camera lens.

8.Replace the dome cover  
a. Install 3/4" cable entry sealing plug (G3) on the dome base.  
b. Push the cables (G1 and G2) through the dome base and 3/4" cable entry sealing plug (G3), make sure the sealing plug is properly installed on the base.  
c. Replace the dome cover (F2) and rotate to close it as shown in fig F. Use the supplied T6 screw to secure the lid to prevent tampering (see fig. G).

9. Using the quick install adaptor see figure H  
a. Install 1/2" cable entry sealing plug (H2) on quick install adaptor (H1). Push the quick install adaptor into the appropriate cut out hole.  
b. Use the screws to adjust the position of the two locking arms (B1) on the quick install adaptor to adjust to the mounting surface.  
c. Push the cables through the opening (H1) and 1/2" cable entry sealing plug (H2), make sure the sealing plug is properly installed on the adaptor;  
d. Thread the dome onto the quick install adaptor.  
This takes about 1½ turns. DO NOT OVERTIGHTEN.  
(Return to Step 5. to complete the installation).

## Template

### Surface mount (In a wall or ceiling)

**Using Quick Install Adaptor:**  
Create an aperture in the mounting surface to a diameter of 1.3" (35mm) as indicated by "T5".

**Using screws:** Create three holes at template positions 'D5' of diameter ¼ (7.5mm) and insert a wall plug into each. Use three D5 screws.

### Cable access

The cables are threaded through the base knockout (shown in C1 overleaf). It is threaded for use with the quick install adapter.

When mounting the dome on a surface with the three D5 screws, use one of the side knock-outs as indicated by C3 shown in fig C overleaf for cable entry. See "Installing the dome enclosure" for instructions on how to drill a hole on the side knock-out.

## Camera OSD Menu

### Page 1

Lens	MANUAL	MODE	OUTDOOR	1/30(25)
	DC		INDOOR	1/60(50)~1/50000
		IRIS SPEED	0~15	RETURN
		RETURN		RET/SAVE&END
EXPOSURES	SHUTTER	AUTO/1/25~X30/---		
	AGC	0~15		
	SENS-UP	OFF		
		AUTO	X2~X30	
	BRIGHTNESS	1~100		
	D-WDR	OFF		
		AUTO	LEVEL	0~8
		ON	RETURN	RET/SAVE&END
	DEFOG	OFF		
		AUTO	POS/SIZE	
			GRADATION	0~2
			DEFAULT	
		RETURN		RET/SAVE&END
BACKLIGHT	OFF		LEVEL	MIDDLE/HIGH/LOW
	BLC		AREA	
		DEFAULT		
		RETURN		RET/SAVE&END
		SELECT	AREA1/AREA2/AREA3/AREA4	
		DISPLAY	ON/OFF	
	HSBLC	BLACK MASK	ON/OFF	
		LEVEL	0~100	
		MODE	NIGHT	0~255
		DEFAULT	ALL DAY	RETURN
		RETURN		RET/SAVE&END
WHITE BAL	ATW			
	AWC->SET			
	INDOOR			
	OUTDOOR			
	MANUAL	BLUE	0~100	
		RED	0~100	
		RETURN		RET/SAVE&END
	EXT	D->N(DELAY)	3~60	
		N->D(DELAY)	3~60	
DAY & NIGHT	AUTO	D->N(AGC)	1~204	
		D->N(DELAY)	1~60	
		N->D(AGC)	1~204	
		N->D(DELAY)	1~60	
	COLOR			
	B/W	BURST	ON/OFF	
		IR SMART	ON/OFF	LEVEL 0~15
		RETURN		AREA
		RETURN		RET/SAVE&END
NR	2DNR	OFF/LOW/MIDDLE/HIGH		
	3DNR	OFF/LOW/MIDDLE/HIGH(*3DNR function is not available under CVBS mode)		
	RETURN			RET/SAVE&END

### Page 2

	CAM TITLE	OFF/ON		
		FREEZE	OFF/ON	
	D-EFFECT	MIRROR	OFF/MIRROR/V-FLIP/ROTATE/---	
		NEG.IMAGE	OFF/ON	
		RETURN		RET/SAVE&END
MOTION	OFF			
	ON	SELECT	AREA1/AREA2/AREA3/AREA4	
		DISPLAY	OFF/ON	
		SENSITIVITY	0~100	
		COLOR	WHITE/RED/GREEN/BLUE	
		TRANS	1.0/0.75/0.25/0.00	
		VIEW TYPE	ALL/OFF/BLOCK/OUTLINE	
	ALARM	OSD VIEW	ON/OFF	
		ALARM OUT	ON/OFF	
		TIME	0~15	
		RETURN		RET/SAVE&END
	DEFAULT			
	RETURN			RET/SAVE&END
PRIVACY	OFF			
	ON	SELECT	AREA1/AREA2/AREA3/AREA4	
		DISPLAY	OFF/MOSAIC/INV./INV./COLOR	
		COLOR	WHITE/BLACK/RED/BLUE/YELLOW/GREEN/CYAN/USER	
		TRANS	1.00/0.75/0.5/0.25	
		DEFAULT		
		RETURN		
SPECIAL	LANGUAGE	ENG/CHN1/CHN2/GER/FRA/ITA/SPA/POL/RUS/POR/NED/TUR		
		AGC LEVEL	0~255	
		LEVEL	0~100	
		RETURN		RET/SAVE&END
	LIVE DPC	ON		
		OFF		
		POS/SIZE		
		START		
		DPC VIEW	OFF/ON	
		LEVEL	0~100	
		AGC	0~14	
		SENS-UP	X2~X30	
		RETURN		RET/SAVE&END
	WHITE DPC	ON		
		OFF		
		POS/SIZE		
		START		
		DPC VIEW	OFF/ON	
		LEVEL	0~100	
		RETURN		RET/SAVE&END
	BLACK DPC	ON		
		OFF		
		POS/SIZE		
		START		
		DPC VIEW	OFF/ON	
		LEVEL	0~100	
		RETURN		RET/SAVE&END
RS485	CAM ID	0~255		
	ID DISPLAY	OFF/ON		
	BAUDRATE	2400/4800/9600/19200/38400		
	RETURN			RET/SAVE&END
	RETURN			RET/SAVE&END
SHARPNESS	AUTO	LEVEL	0~10	
	OFF	START AGC	0~255	
		END AGC	0~255	
		RETURN		RET/SAVE&END
ADJUST	MONITOR	LCD	GAMA	USER/0.45~1.0
			BLUE GAIN	0~100
			RED GAIN	0~100
			RETURN	RET/SAVE&END
		CRT	BLUE GAIN	0~100
			RED GAIN	0~100
			RETURN	RET/SAVE&END
	LSC	OFF/ON		
	VIDEO.OUT	NTSC/PAL		
	RETURN			RET/SAVE&END
EXIT				SAVE&END/RESET/NOT SAVE

deView Electronics  
1420 Lakeside Parkway, Suite 110  
Flower Mound, Texas 75028, USA  
Toll Free: 1.877.4deView / 1.877.433.8439

deView Europe  
Falcon Court, Petre Road,  
Clayton le Moors, Accrington,  
Lancashire, England. BB5 5JZ. UK  
TEL: +44 (0) 1254 302490